

RELOOM

VR

1. TURN ON THE HEADSET:

Hold the **POWER** button until the status light turns blue.

2. OPEN FILE MANAGER:

On the **Home Page**, look at the taskbar and hover over **File Manager**, then press the **CONFIRM** button.

3. FIND AND PLAY YOUR VIDEO:

In **File Manager**, hover over your video and press **CONFIRM** to play it.

4. ADJUST SETTINGS:

Use the taskbar to control playback and select the 3D cube icon to set the angle to 360°.

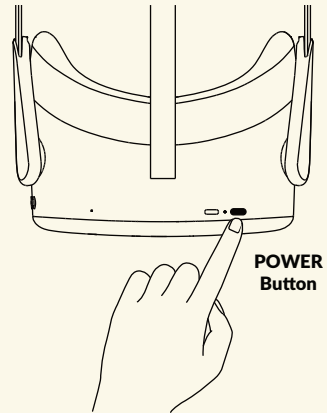

Enjoy your Reloom VR experience!

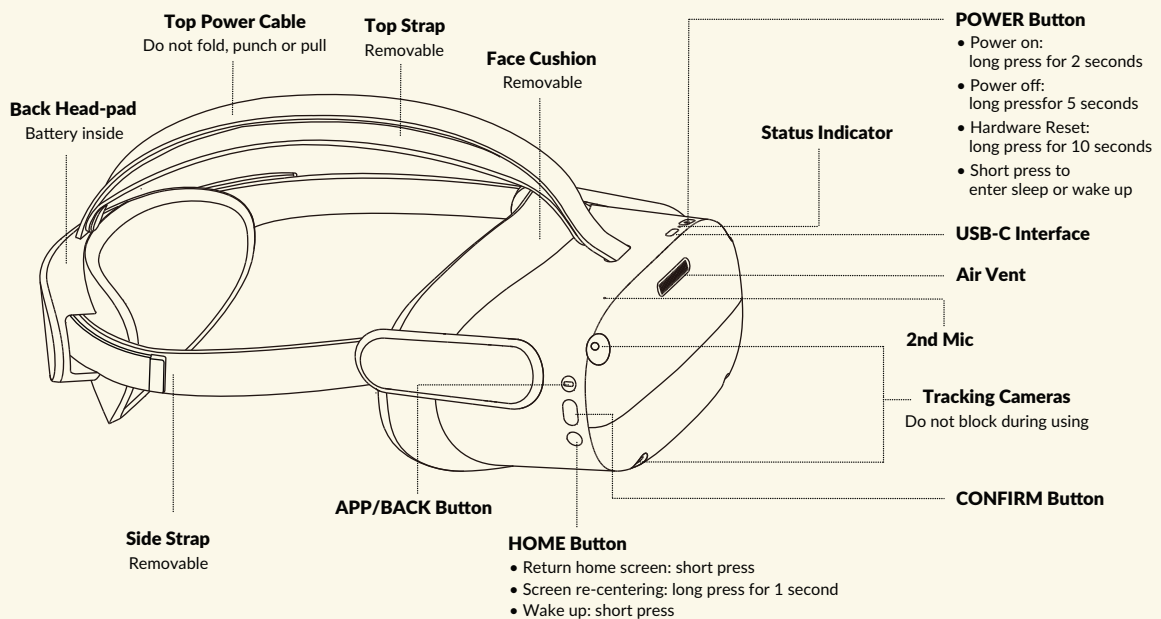

⚠ SAFETY WARNINGS

Children & Pets: Keep out of reach. Small parts and cables may cause choking, entanglement, or damage.

Accessories & Charging: Use only manufacturer-approved accessories and chargers. Damaged or wet chargers/cables must not be used.

Battery: Do not disassemble, puncture, expose to liquids, or replace the internal battery yourself. Contact PICO service for replacement.

Hearing: Avoid high volume or prolonged headphone use to prevent hearing damage.

Environment: Dispose of headset and batteries at approved collection points. Do not burn or incinerate.

Flammable Areas: Do not use or store near fuel, flammable materials, or explosives.

Transportation: Do not use while driving, cycling, or walking. Motion may cause dizziness or sickness.